

Fuel Supply System

Fuel Tank (2WS)

Replacement

⚠ WARNING Do not smoke while working on fuel system. Keep open flame away from work area.

1. Block front wheels. Jack up the rear of the car and support with jackstands.
2. Remove the drain bolt and drain the fuel into an approved container.
3. Disconnect the 3P connector in the trunk.
4. Remove the two-way valve cover and fuel hose protector.
5. Disconnect the hoses.

CAUTION:

- When disconnecting the hoses, slide back the clamps, then twist hoses as you pull, to avoid damaging them.
- Clean the flared joint of high pressure hoses thoroughly before reconnecting them.

6. Place a jack, or other support, under the tank.
7. Remove the strap and let the straps fall free.
8. Remove the fuel tank.

NOTE: The tank may stick on the undercoat applied to its mount. To remove, carefully pry it off the mount.

9. Install a new washer on the drain bolt, then install parts in the reverse order of removal.

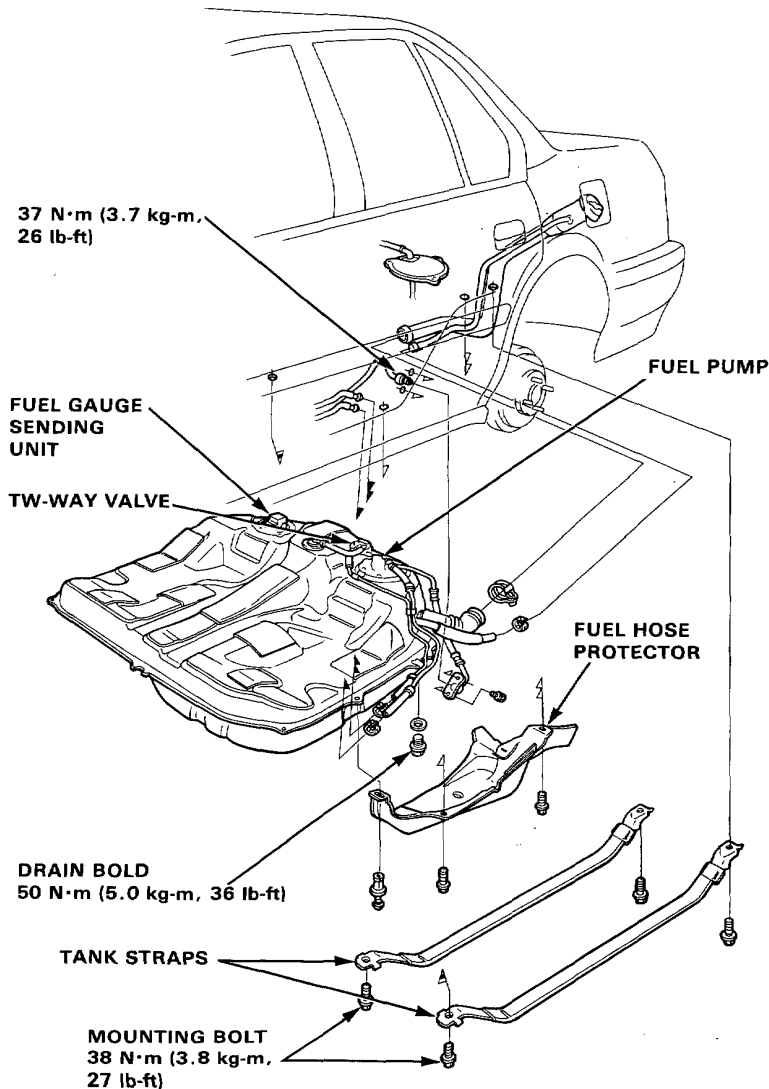



Fuel Tank (4WS)

Replacement

⚠ WARNING Do not smoke while working on fuel system. Keep open flame away from work area.

1. Block front wheels. Jack up the rear of the car and support with jackstands.
2. Remove the drain bolt and drain the fuel into an approved container.
3. Disconnect the 4P in the trunk.
4. Remove fuel hose protector.
5. Disconnect the hoses.

CAUTION:

- When disconnecting the hoses, slide back the clamps, then twist hoses as you pull, to avoid damaging them.
 - Clean the flared joint of high pressure hoses thoroughly before reconnecting them.
6. Place a jack, or other support, under the tank.
 7. Remove the strap bolts and let the straps fall free.
 8. Remove the fuel tank.
 9. Install a new washer on the drain bolt, then install parts in the reverse order of removal.

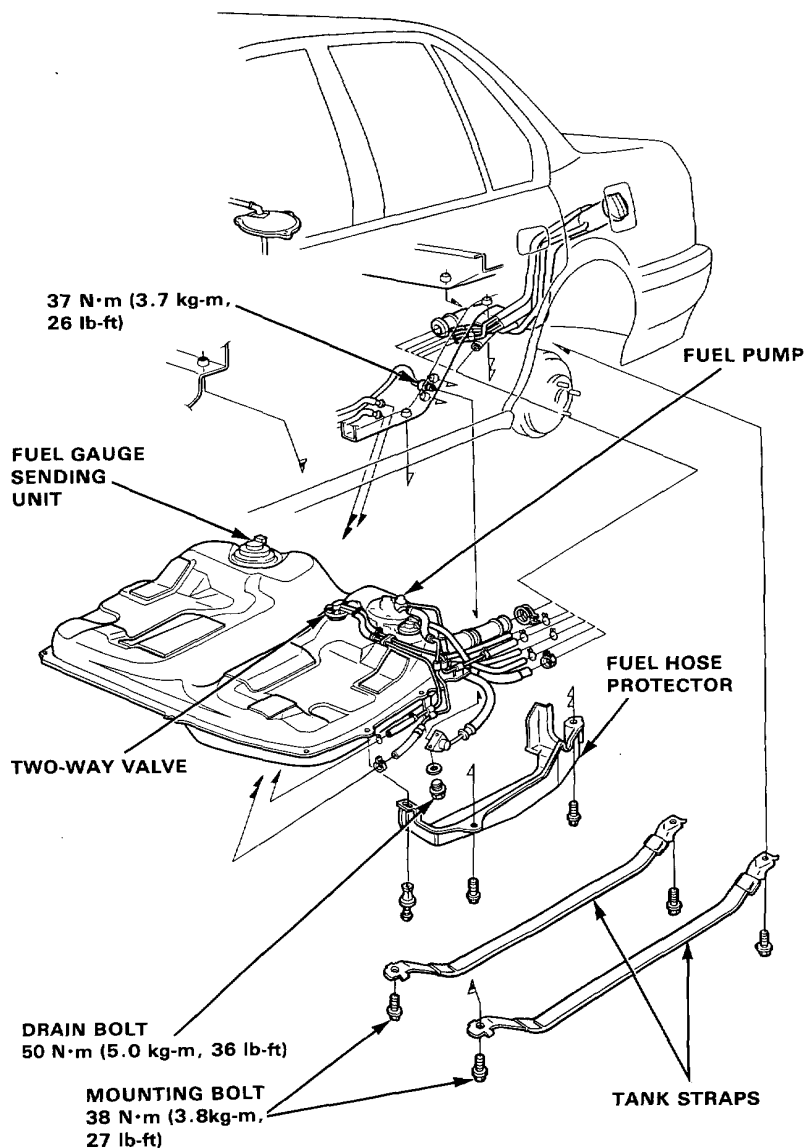

Air Intake System

System Troubleshooting Guide



NOTE: Across each row in the chart, the sub systems that could be sources of a symptom are ranked in the order they should be inspected starting with ①. Find the symptom in the left column, read across to the most likely source, then refer to the page listed at the top of that column. If inspection shows the system is OK, try the next system ②, etc.

2.0 l and KQ, KY:

PAGE	SUB SYSTEM	THROTTLE CABLE	THROTTLE BODY	INTAKE CONTROL SYSTEM
		222	223	229
SYMPTOM				
WHEN WARM RPM TOO HIGH		②	①	
LOSS OF POWER			①	②

2.2 l except KQ, KY:

PAGE	SUB SYSTEM	THROTTLE CABLE	THROTTLE BODY	INTAKE CONTROL SYSTEM	BYPASS CONTROL
		222	223	229	225
SYMPTOM					
WHEN WARM RPM TOO HIGH		②	①		
LOSS OF POWER			①	③	②